

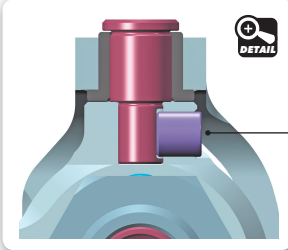

4x 901404
SB M4x4

2x

L=R



NOTE
ORIENTATION
!

RIGHT STEERING BLOCK

NOTE
ORIENTATION
!

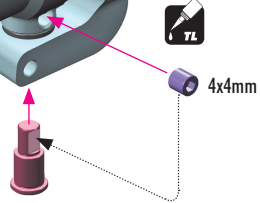

2x

L=R

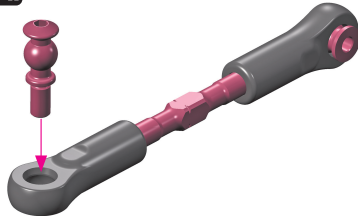

TIP Install the pivot balls with
Professional Multi Tool (HUDY #183011)



2x

L=R

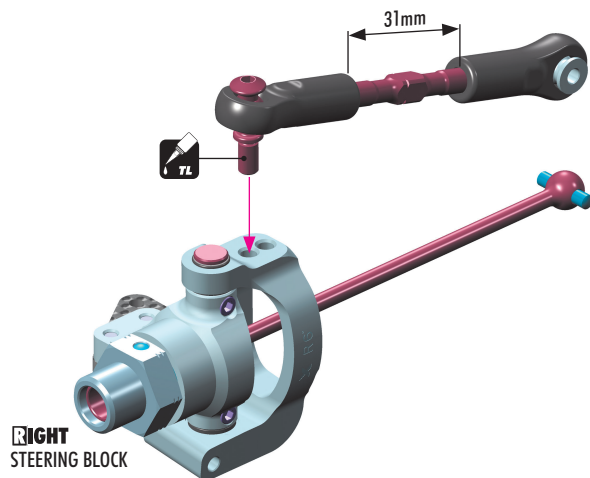

RIGHT STEERING BLOCK

XRAY GTX

350911 XRAY GTX8/GTXE Alu Front & Rear Suspension Conversion Set

This is a complete front and rear suspension conversion set for GTX and GTXE that will replace the standard composite suspension parts.

2x

L=R

REAR

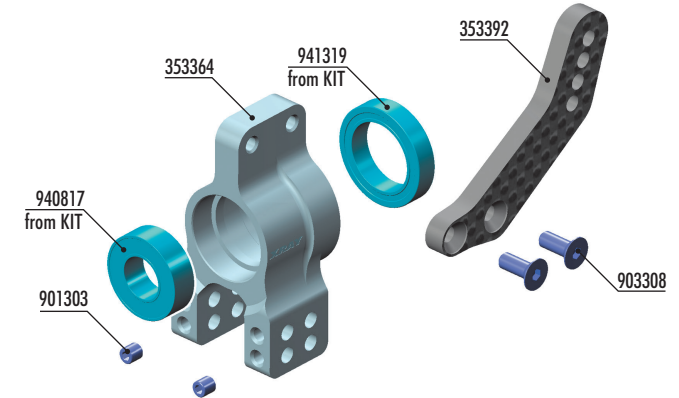

353364 GT ALU REAR UPRIGHT - SWISS 7075 T6
353392 GT GRAPHITE EXTENSION FOR ALU REAR UPRIGHT (1+1)
901303 HEX SCREW SB M3x3 (10)

903308 HEX SCREW SFH M3x8 (10)
940817 BALL-BEARING 8x16x5 RUBBER SEALED - OIL (2)
941319 BALL-BEARING 13x19x4 RUBBER SEALED - OIL (2)

4x 901303
SB M3x3



4x 903308
SFH M3x8



2x 940817
BB 8x16x5



941319
BB 13x19x4
2x

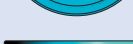
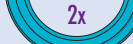
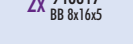

2x

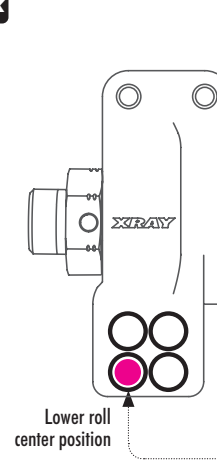

Lower roll
center position

LEFT UPRIGHT

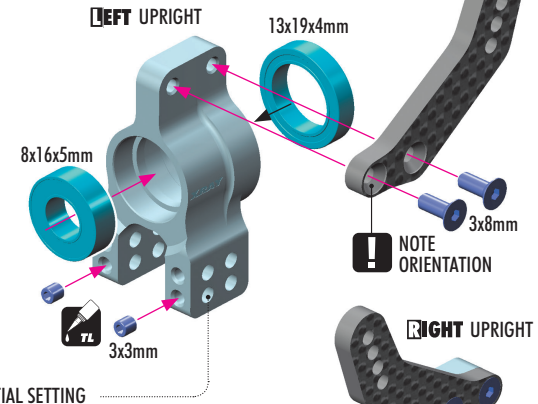

NOTE
ORIENTATION
!

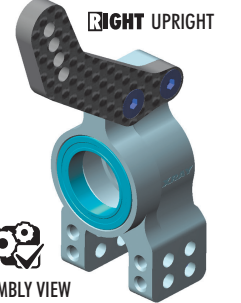

ASSEMBLY VIEW

2x FRONT

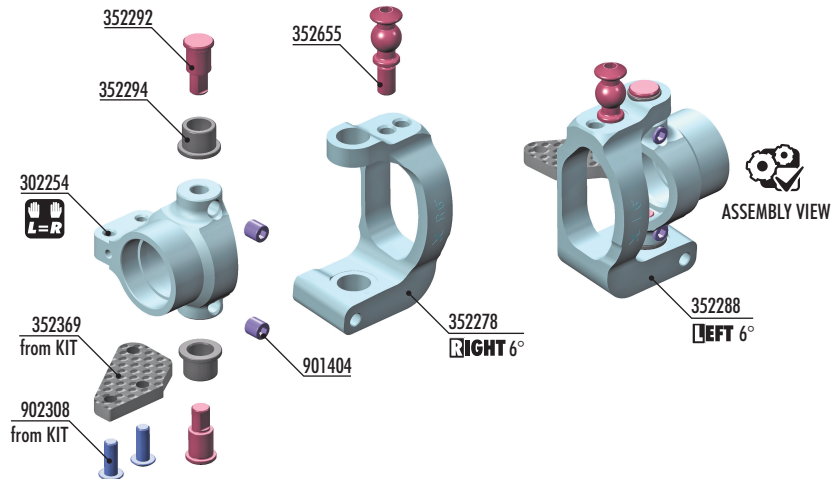

352254 ALU STEERING BLOCK - SWISS 7075 T6
 352278 ALU CASTER BLOCK 6° RIGHT - SWISS 7075 T6
 352288 ALU CASTER BLOCK 6° LEFT - SWISS 7075 T6
 352292 STEEL STEERING BLOCK PIVOT PIN (2)
 352294 COMPOSITE BUSHING FOR ALU CASTER BLOCK (2)

352369 GRAPHITE STEERING PLATE (2)
 352655 BALL STUD 6.8mm WITH BACKSTOP L=6mm - M4 (2)
 901404 HEX SCREW SB M4x4 (10)
 902308 HEX SCREW SH M3x8 (10)

2x 980317
P 3x17



2x 901504
SB M5x4

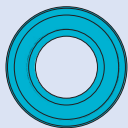

2x 940816
BB 8x16x5



941319
BB 13x19x4
2x

2x FRONT

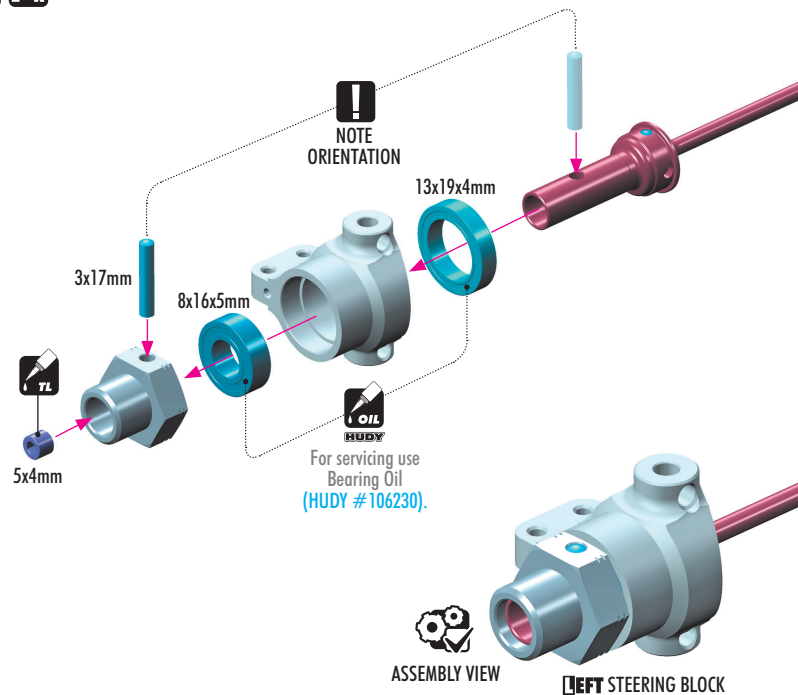

2x 902308
SH M3x8

2x

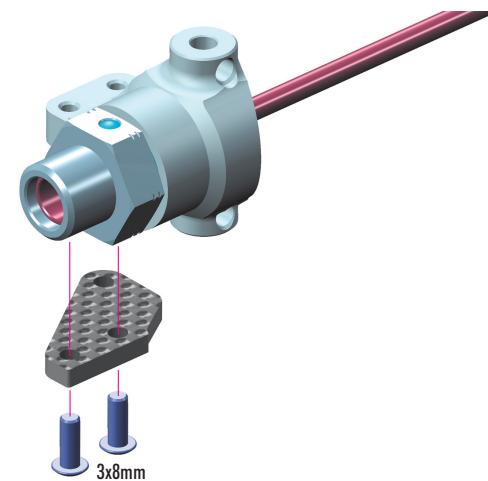

2x

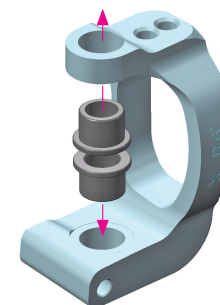

2x

